



STRATHMORE COURT, ST JOHNS WOOD, NW8

£3,100 Per Week

T. +44 (0) 20 7935 0011  
E. [enquire@napierwatt.co.uk](mailto:enquire@napierwatt.co.uk)  
[WWW.NAPIERWATT.CO.UK](http://WWW.NAPIERWATT.CO.UK)

**NAPIER WATT**

PROPERTY CONSULTANTS

## Description

A beautiful four bedroom penthouse apartment located in a prestigious mansion block offering fabulous views over Regent's Park. The penthouse is set over 2135 sq ft and comprises a large dual aspect reception/dining room benefitting from a south facing private balcony with magnificent views over Regent's Park, master bedroom with a dressing room and en suite bathroom with a jacuzzi allowing stunning views over Regent's Park, three further bedrooms with en suite bathrooms, kitchen, guest bathroom and cloakroom. The apartment

offers easy access to the famous Lords Cricket Ground, the open spaces of Regent's Park, along with all the local shops, bars, restaurants located on St John's Wood High Street.

Council tax band G - £1,440.22 per annum.

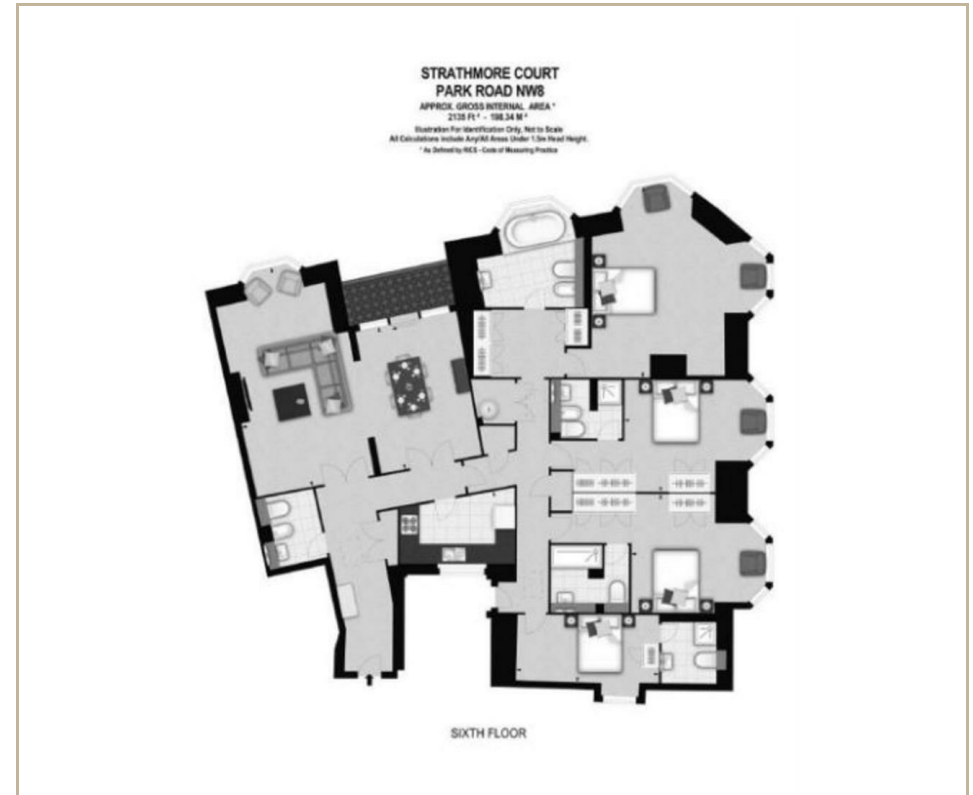

## TERMS

Fees & Charges: Tenancies exceeding £100,000 Per annum £480 inc VAT, Tenancies where a company is a tenant £480 Inc VAT.

**For Clarification** we wish to inform prospective purchasers that we have prepared these sales particulars as a general guide. We have not carried out a survey, nor tested the services, appliances and specific fittings. Room sizes are approximate and rounded: they are taken between internal wall surfaces and therefore include cupboards/shelves, etc. Accordingly, they should not be relied upon for carpets and furnishings. Formal notice is given that all fixtures and fittings, carpeting, curtains/blinds and kitchen equipment, whether fitted or not, are deemed to be removable by the vendor unless specifically itemised within these sales particulars.

T. +44 (0) 20 7935 0011  
E. [enquire@napierwatt.co.uk](mailto:enquire@napierwatt.co.uk)  
[WWW.NAPIERWATT.CO.UK](http://WWW.NAPIERWATT.CO.UK)

**NAPIER WATT**  
PROPERTY CONSULTANTS